

K 225; QR40; 803-106

$d' = d = 0,10 \text{ ht}$   
tabel GTB 1962, 10-10

$\omega = 0,4$  praktisch

$A = 0,4 \times 4,6 \times 6,0 = 11,08 \text{ cm}^2$   
toegepast  $6 \Phi 16$ ;  $A = 12,06 \text{ cm}^2$

### Kolom EG

$P$  zie berekening EG belast op begane grond  $38249 \text{ kg}$   
 $N = 38249 \text{ kg}$

$$l_c = 2,80 \times 0,7 = 1,96 \text{ m}$$

afm. Kolom.

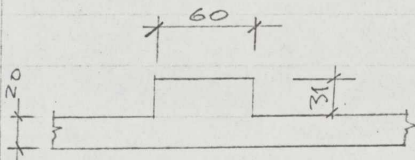

$$B = (60 \times 51) \times 1,3 = 3980 \text{ cm}^2$$

$$G_m = \frac{38249}{3980} = 9,60 \text{ kg/cm}^2$$

$e_0 = 0$ ;

$$\frac{l_c}{h_t} = \frac{196}{51} = 3,85$$

$d' = d = 0,10 \text{ ht}$

$\omega = 0,4$  pract.

$A = 12,25 \text{ cm}^2$

toegepast  $6 \Phi 18$   $A = 15,52 \text{ cm}^2$