

Voorgenomen splitsing  
in appartementsrechten  
van de kadastrale percelen:

Gemeente: Amsterdam  
Sectie: L  
Nummer: 9361 - 9365 - 9366

d.d. de notaris:

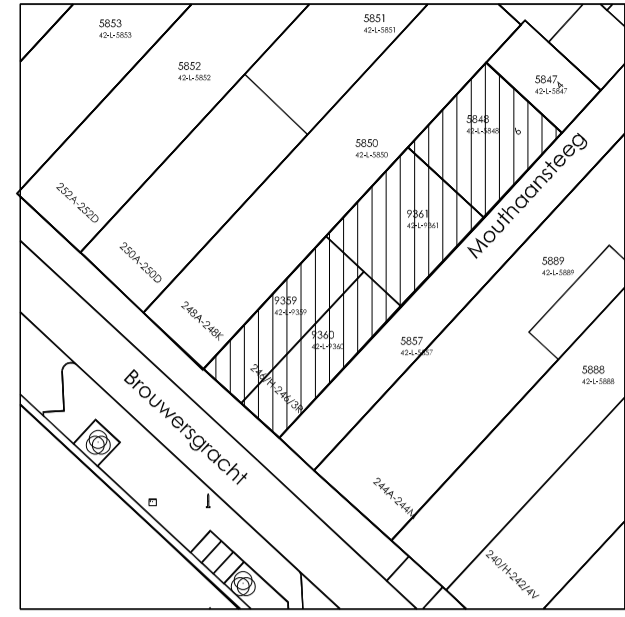

Situatie, schaal 1: 500  
5.1, 2, e

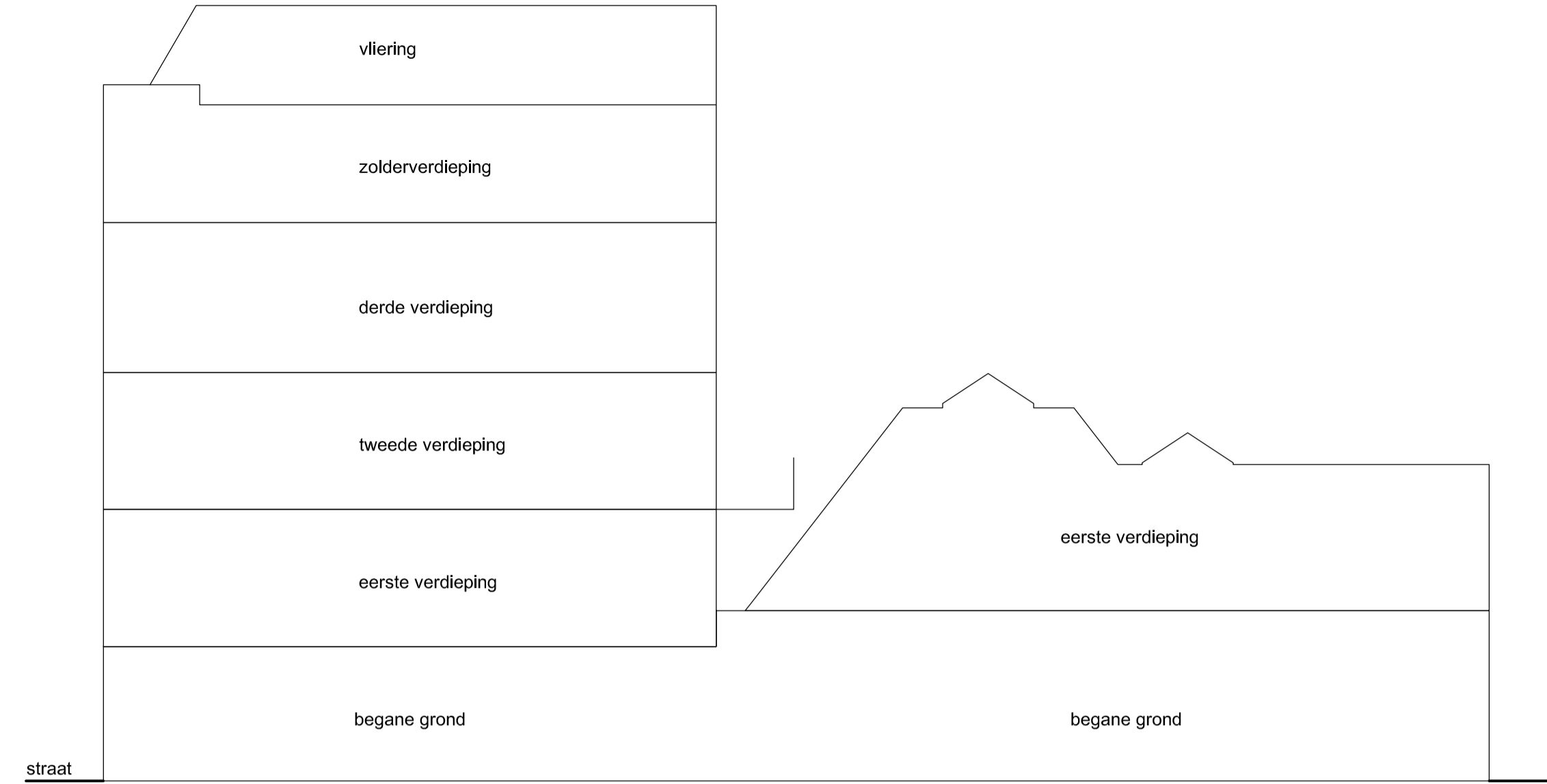

Doorsnede  
schaal 1:100

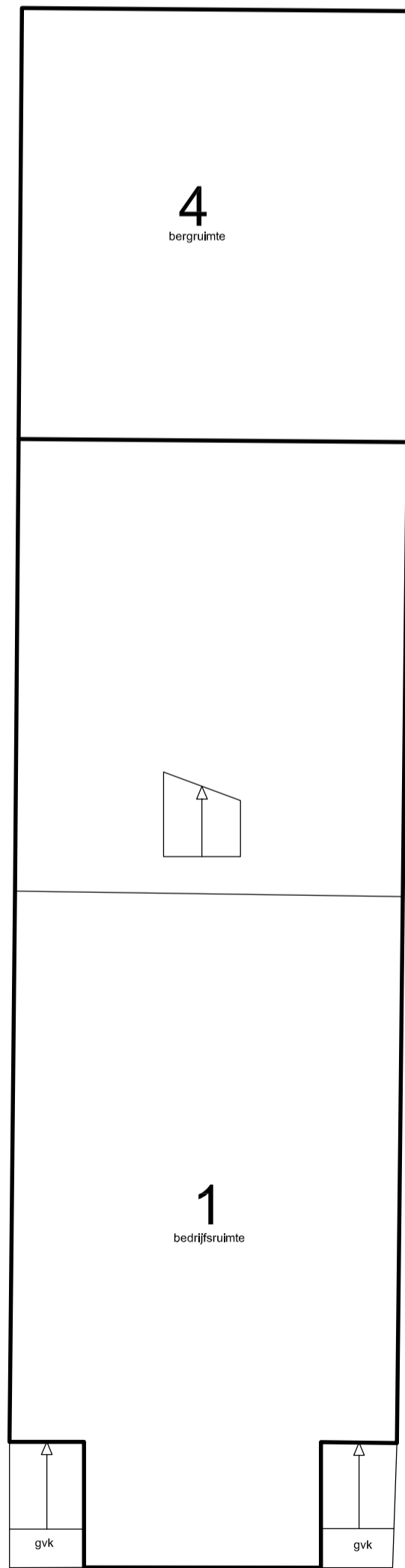

Begane grond  
schaal 1:100

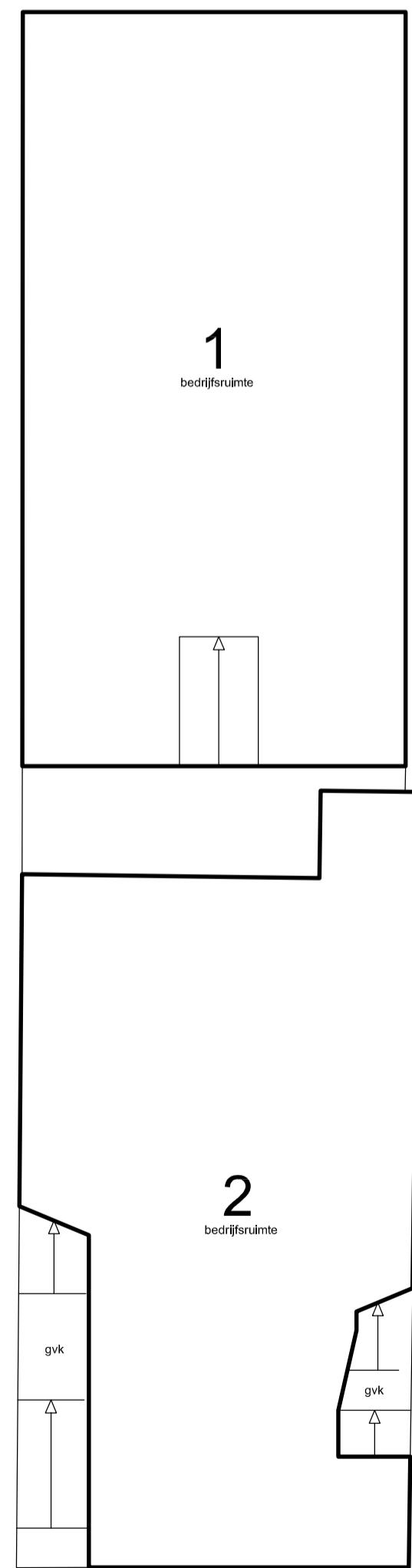

Eerste verdieping  
schaal 1:100

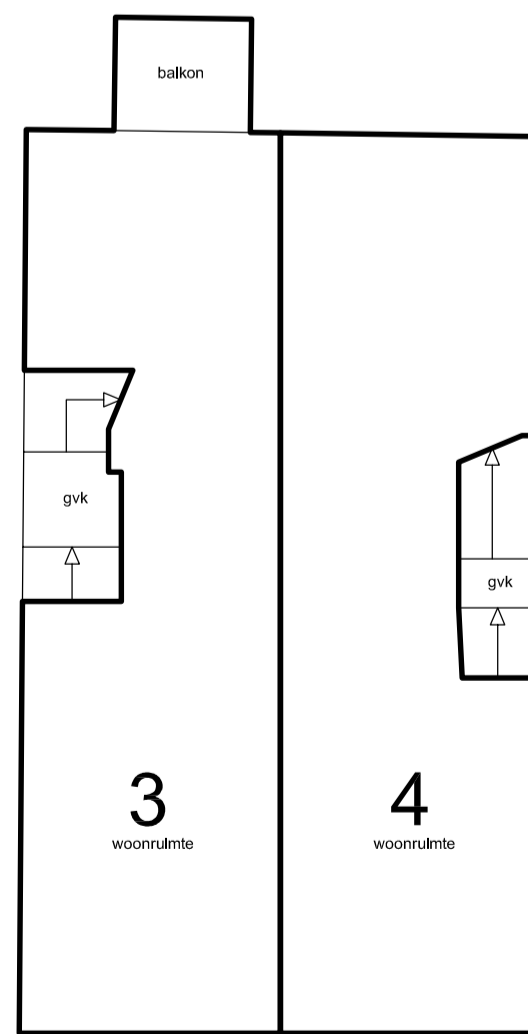

Tweede verdieping  
schaal 1:100

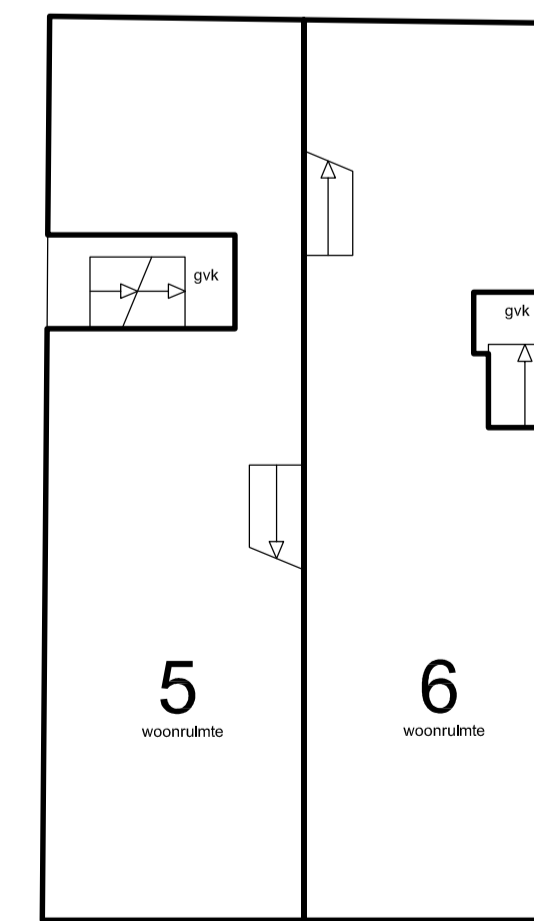

Derde verdieping  
schaal 1:100

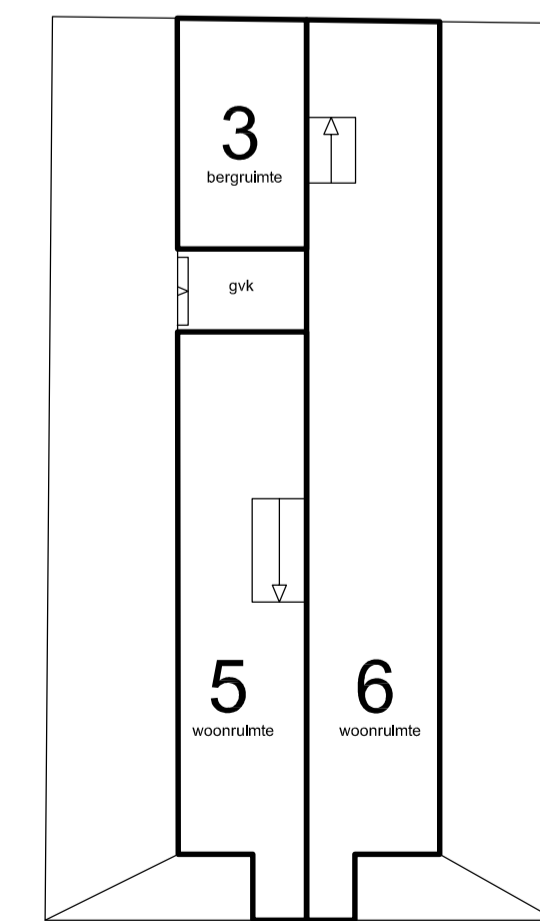

Zolder verdieping  
schaal 1:100

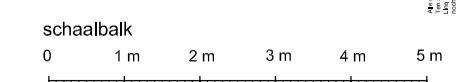

5.1, 2, e  
Amsterdam

Onderwerp: Splitsingstekening

Fase: Splitsingsaanvraag

Datum: 08-02-2024

Gewijzigd:

Schaal: 1: 100

Werknummer: 22116

Tek. nr: S.01

**LIHQ**  
MAKES BETTER  
ARCHITECTURE