

OVERZICHT BOTENHUIS
 schaal: 1 : 100

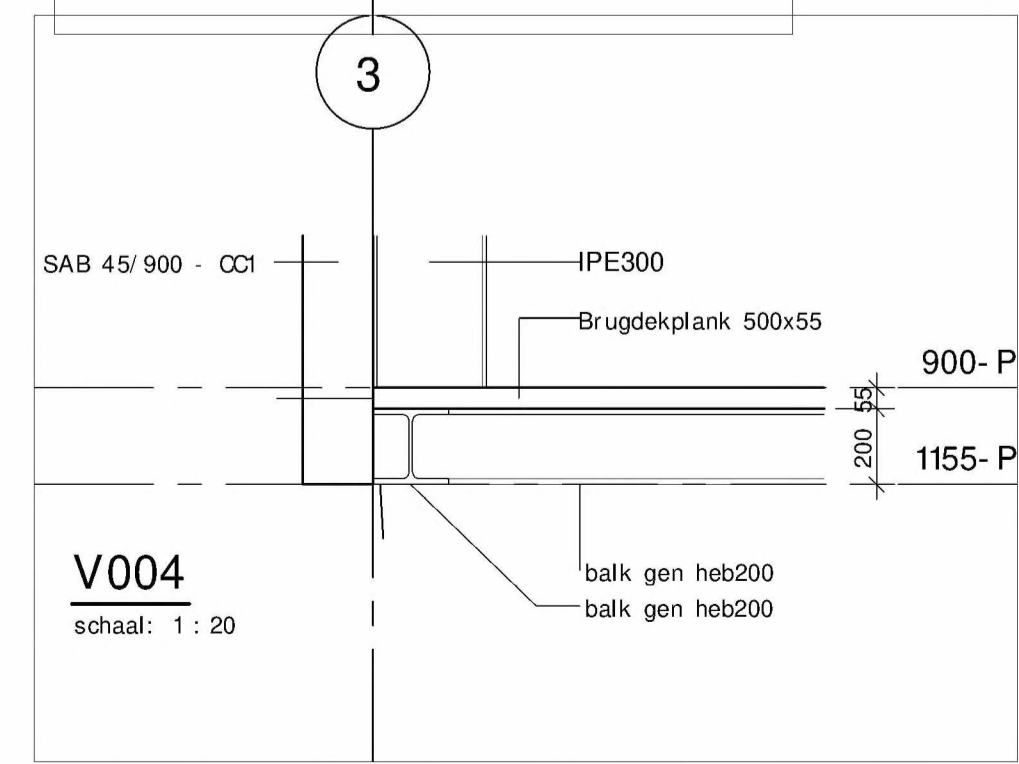

PRINCE DETAILS: OP HET LAND

PRINCE DETAILS: OP HET WATER

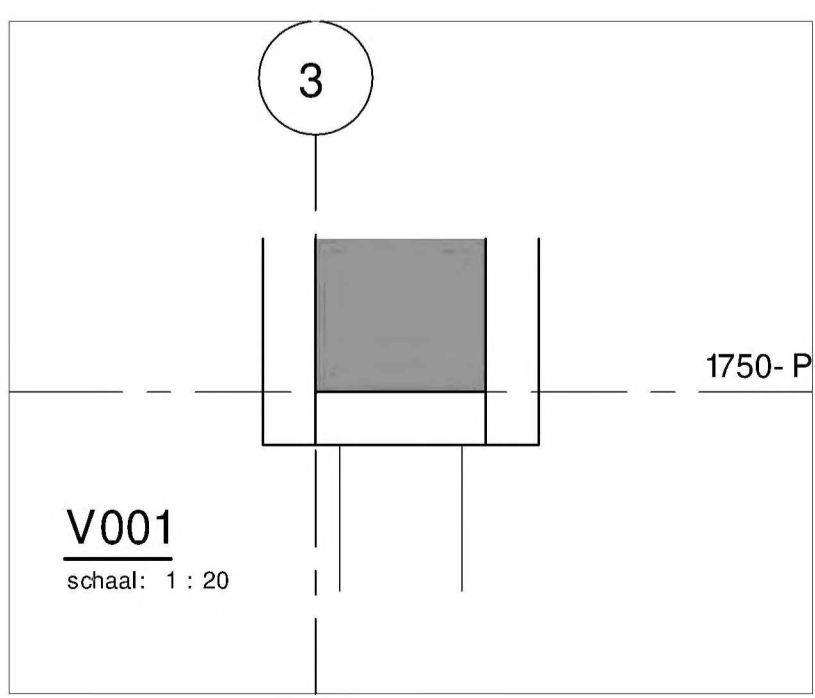
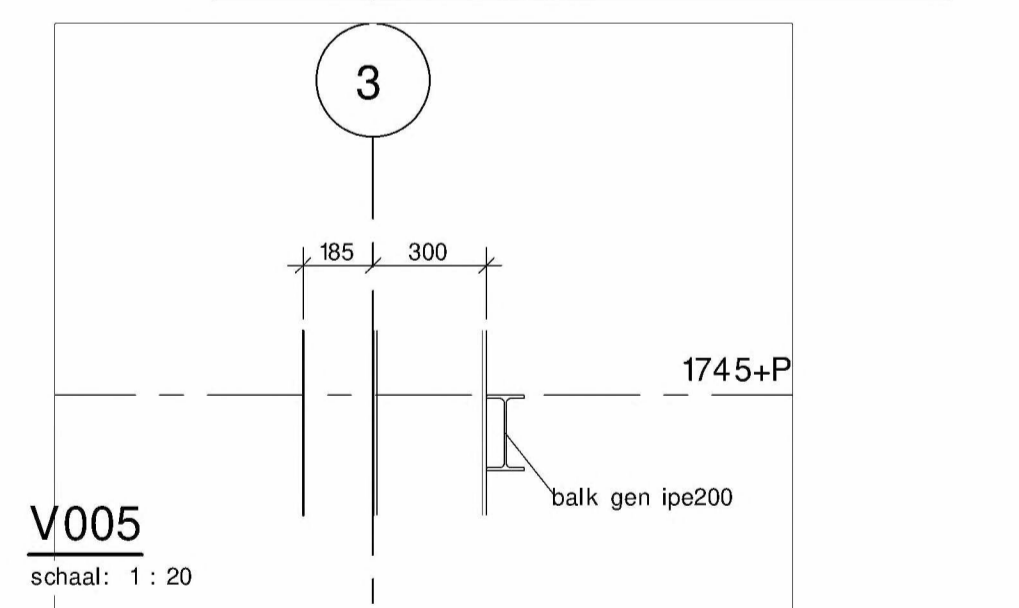
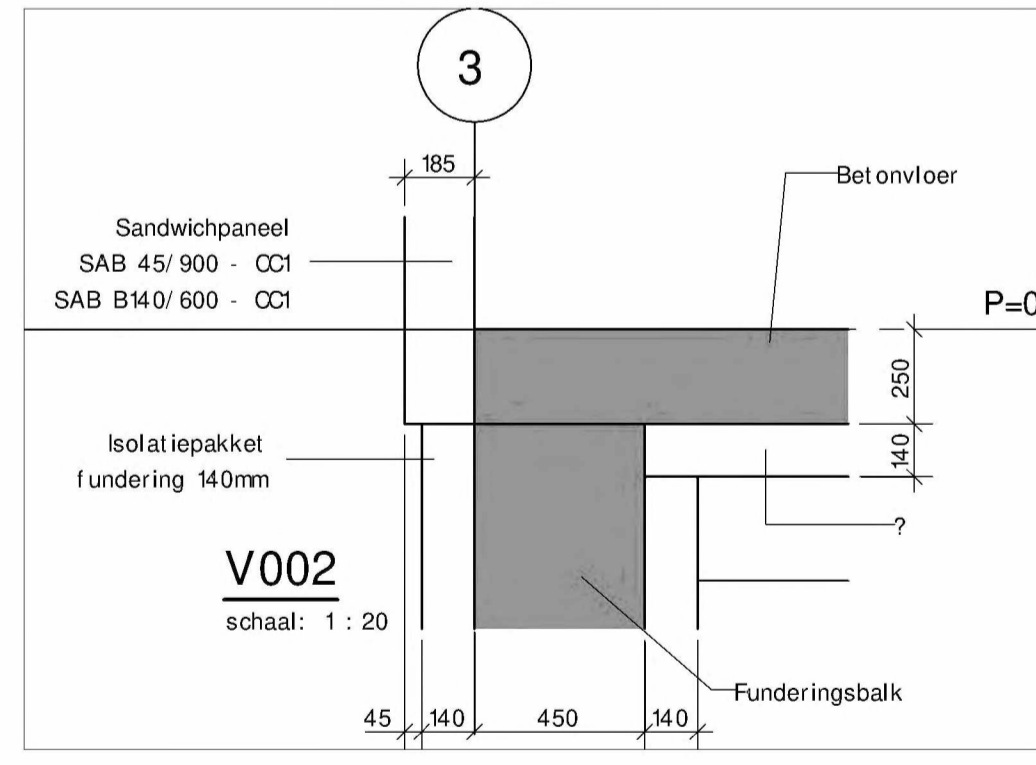
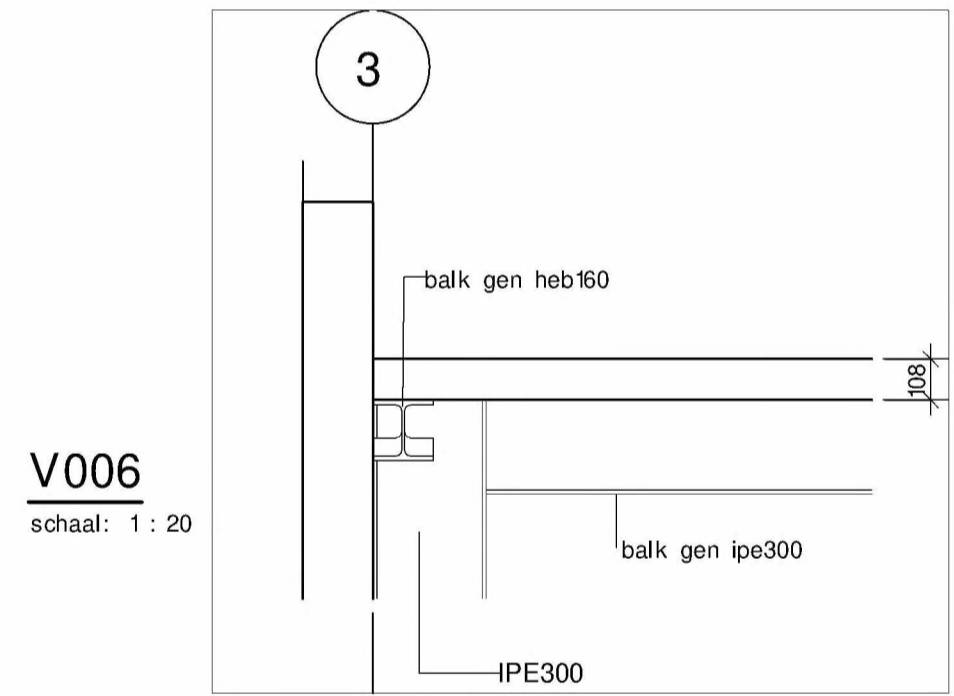
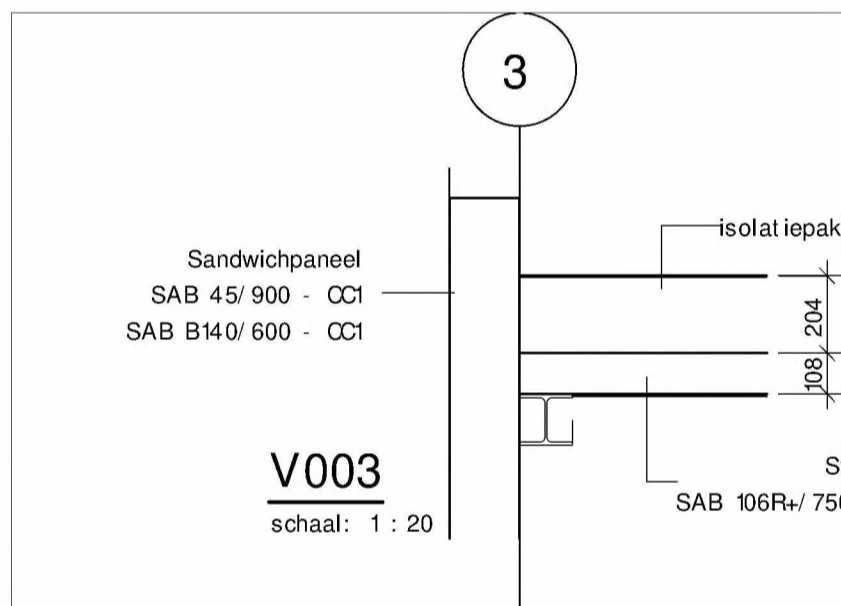
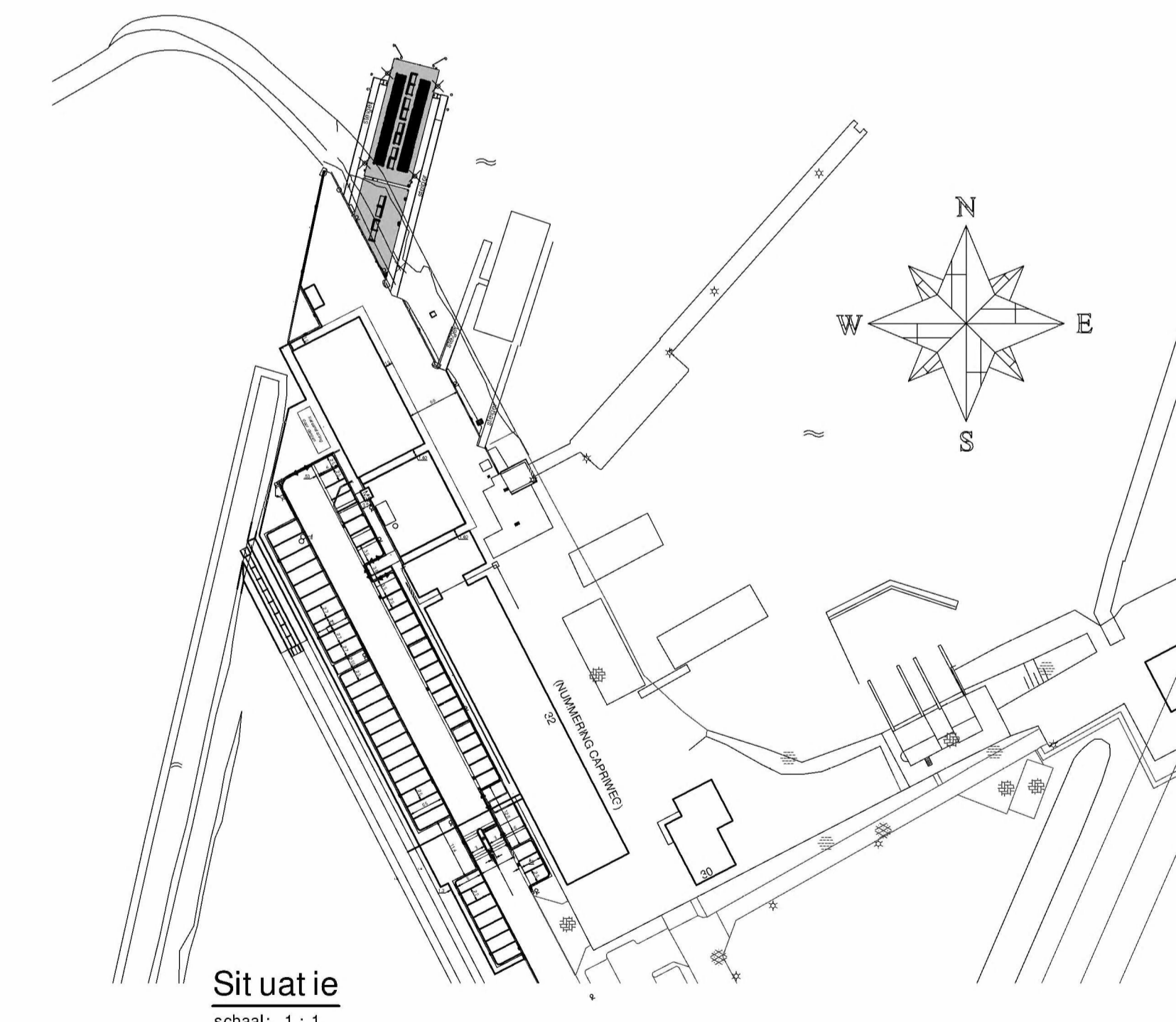

| Rev. | Datum | R/O | Gewijz. | Omschrijving |
|------|------------|-----|---------|--------------------|
| 0.1 | 21-10-2022 | RJO | | Definitief ontwerp |

| | | | |
|-----------|--------------------------------|----------------|----------------|
| Project | Botenhuis Port of Amsterdam | Status | CONCEPT |
| Onderwerp | Beganevloer | Projectleider | |
| | P=0 - Botenhuis op het land | Datum | 21-10-2022 |
| | S00-P - Botenhuis op het water | Gecontroleerd | |
| | Havenbedrijf Amsterdam NV | Formaat | A1 |
| | | Schaal | |
| | | Tekeningnummer | 21415-DO-B-001 |
| | | Codering | derden |

| | |
|--|--|
| G. Sandersestraat 2, 1039 PV Brakke Postbus 441, 1018 AP Amsterdam T: +31 (0)112 58 83 88 E: drahten@boorsma-consultants.nl | |
| Nieuweweg 17, 3821 BL Amersfoort Postbus 7355, 3808 CA Amersfoort T: +31 (0)31 458 82 22 E: amersfoort@boorsma-consultants.nl | |
| www.boorsma-consultants.nl | |

19-12-2022

