

1/4

Eerste Helmerssteeg 113, Amsterdam  
240498 - overzicht constructie  
15/08/24  
FM

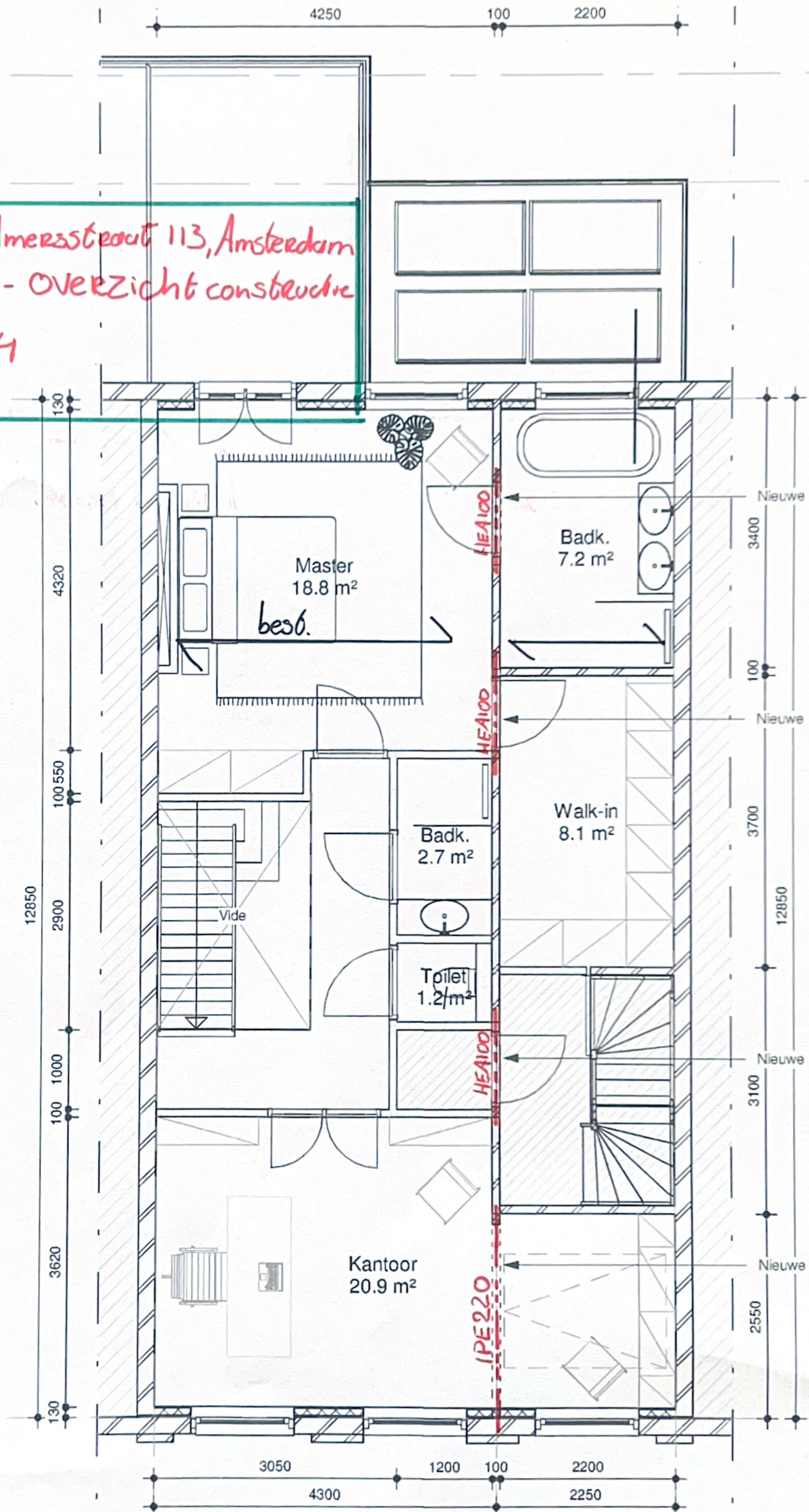

2<sup>e</sup> verdiepingvloer

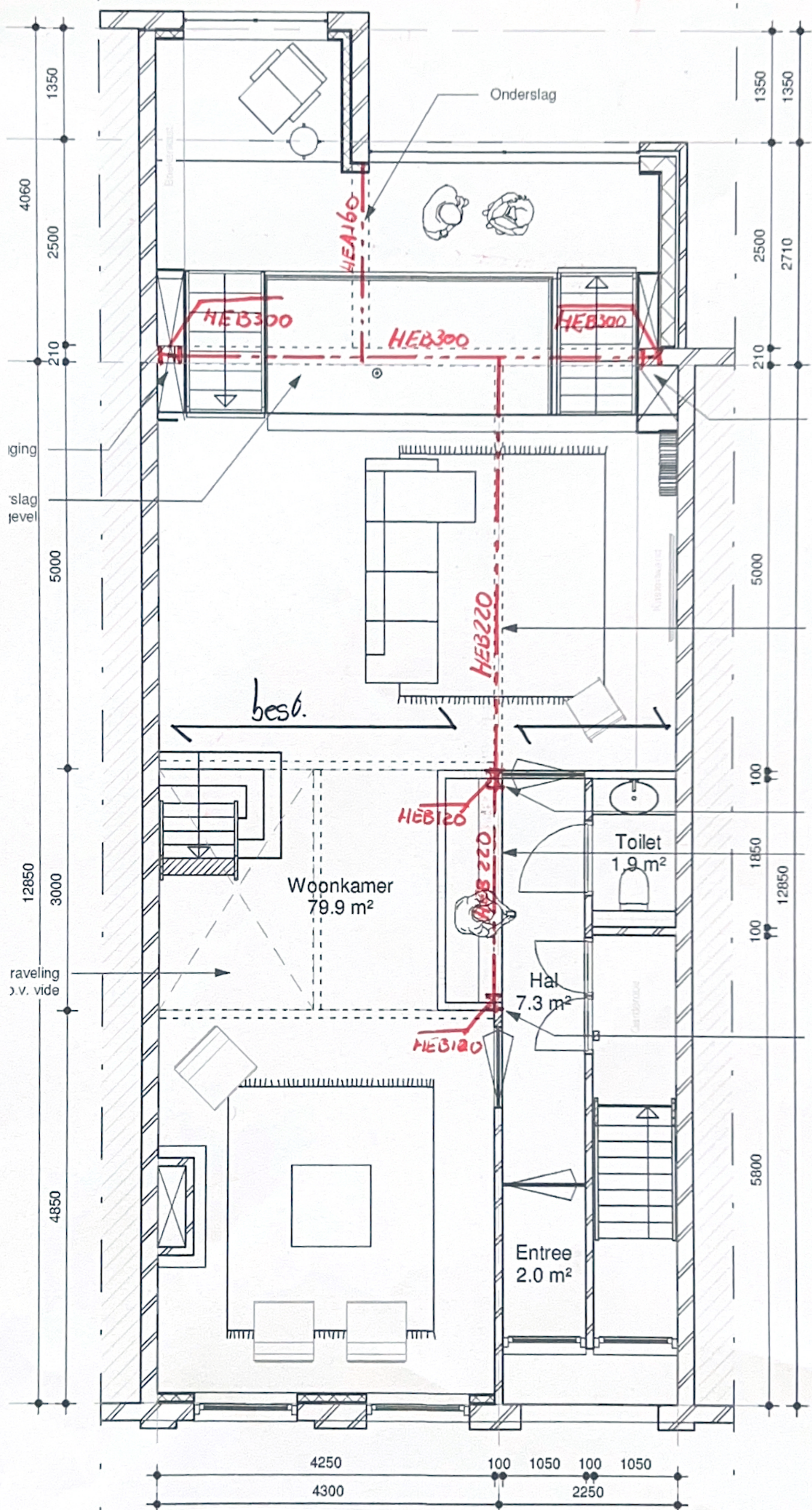

1<sup>e</sup> verdieping vloer

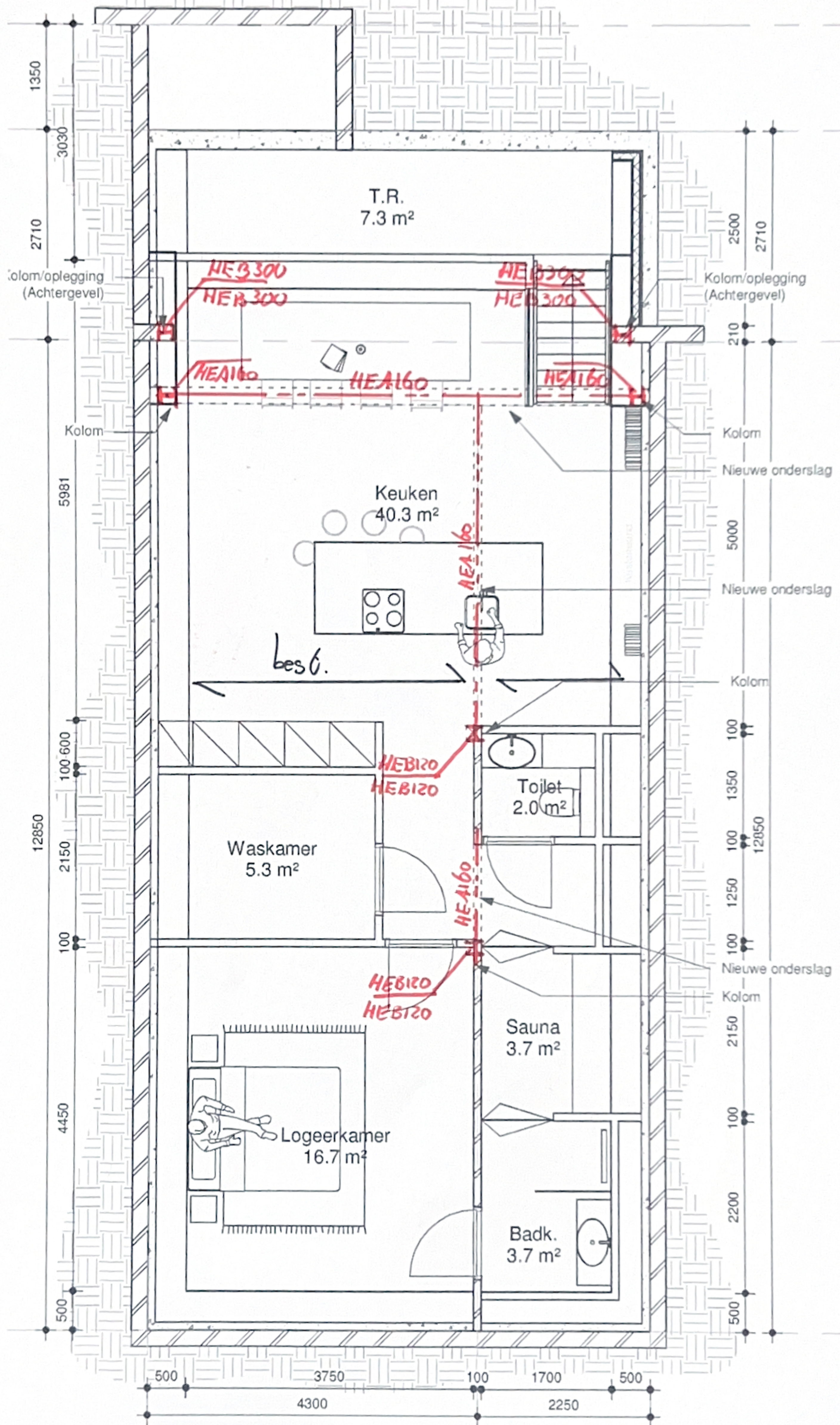

Begane grondvloer

4/4

12 stuks  
Schroef-  
injetie-  
Palen  
500k  
PPN: ntb

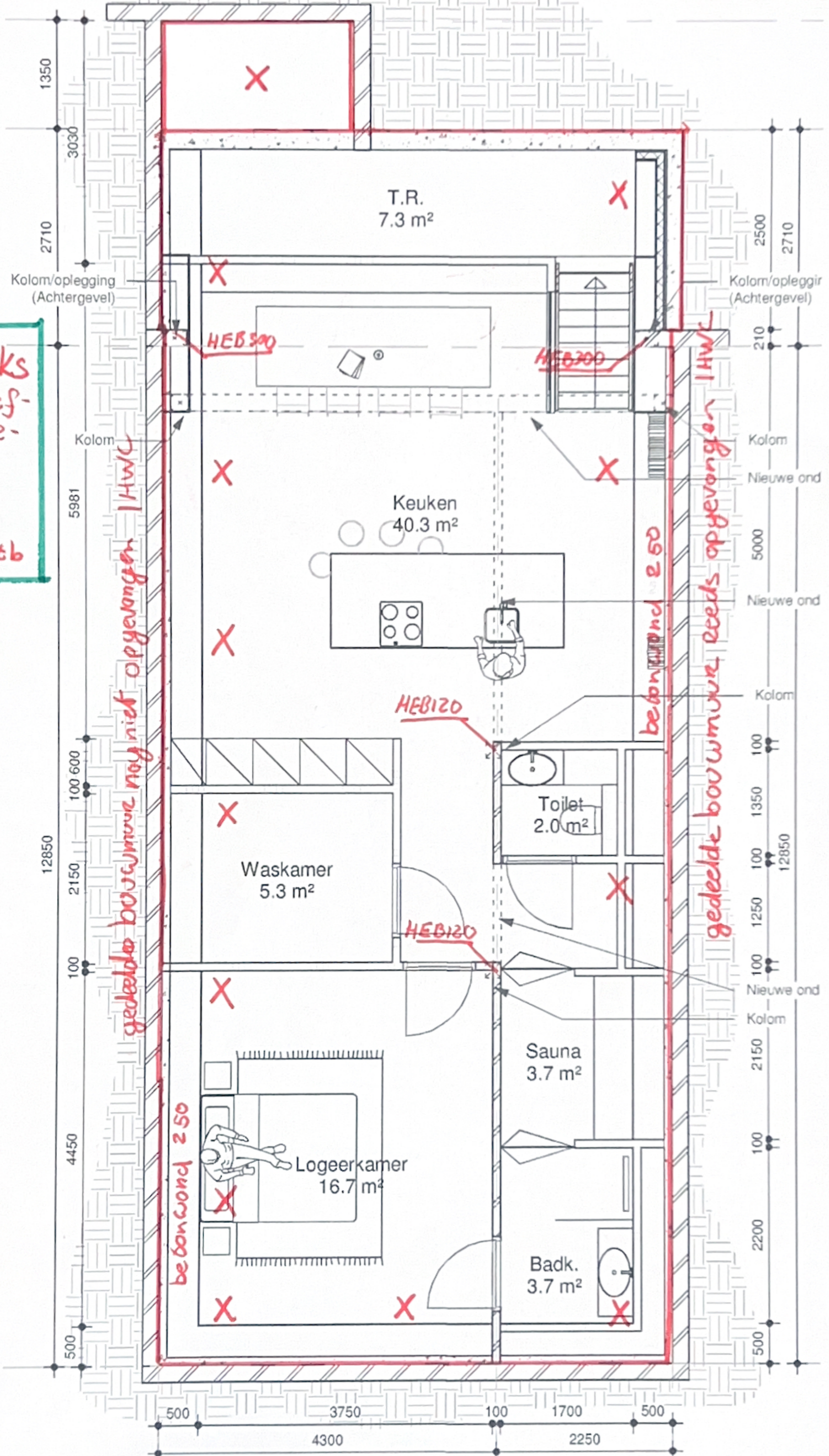

Kelder vloer