

Kolom in as E 2

K 225; QR 40

803-104

P zie berekening E 2 belasting op begane grond = 77975 kg

T_A reactie van balk stramien 2 = 24380 kg

N = 102365 kg

$$l_c = 2,80 \times 0,7 = 1,96 \text{ m}$$

M_A = 39225 kgm zie berekening balk str. 2

afmeting kolom

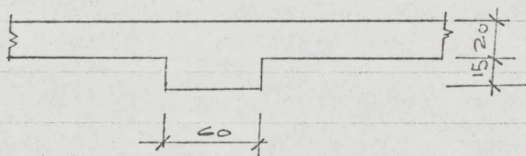

$$B = (60 \times 35) \times 1,3 = 2730 \text{ cm}^2$$

1,3 - toeslag voor wand.

$$G_w = \frac{102365}{2730} = 37,50 \text{ kg/cm}^2$$

$$e_o = \frac{3922500}{102365} = 38,40 \text{ cm}$$

$$\frac{e_o}{h_t} = \frac{38,40}{35} = 1,097 \quad ; \quad \frac{l_c}{h_t} = \frac{196}{35} = 5,60$$

$$d' = d = 0,10 h_t$$

Tabel GTB 1962, 10-10

$$w = 2,37 \quad ; \quad A' = A = 2,34 \times 6 \times 3,5 = 49,20 \text{ cm}^2$$

toegepast 8 Φ 28 $A = 4928 \text{ cm}^2$

bougeels Φ 10 - 25 cm